

Item	Qty.	Description
1	2	Base Plate
2/2A	1/1	33.5" CEI110 Horizontal Extrusion w/ Miter One End
3/3A	1/1	33.5" CEI110 Horizontal Extrusion w/ Miter One End
4/4A	1/1	40" CEI110 Vertical Extrusion w/ Miter Both Ends
5	1	36.353" Z45 Vertical Extrusion

- Steps:
- 1) Attach base plates [1] to extrusions [2] and [3], using bolts.  
See reverse side for CEI-152 Frame Assembly details.
  - 2) Assemble extrusions [2,2A,3,3A,4,4A] together as shown.  
See reverse side for CEI-152 Frame Assembly details.
  - 3) Attach extrusion [5] in center of frame.  
See **Z45 Attachment** detail.
  - 4) Connect lighting power cords and attach transformer.  
See **Light to Light Connection** and **Light to Transformer Connection** details.
  - 5) Install SEG graphic to front and back of assembled frame.  
See **SEG Graphic Installation** detail.

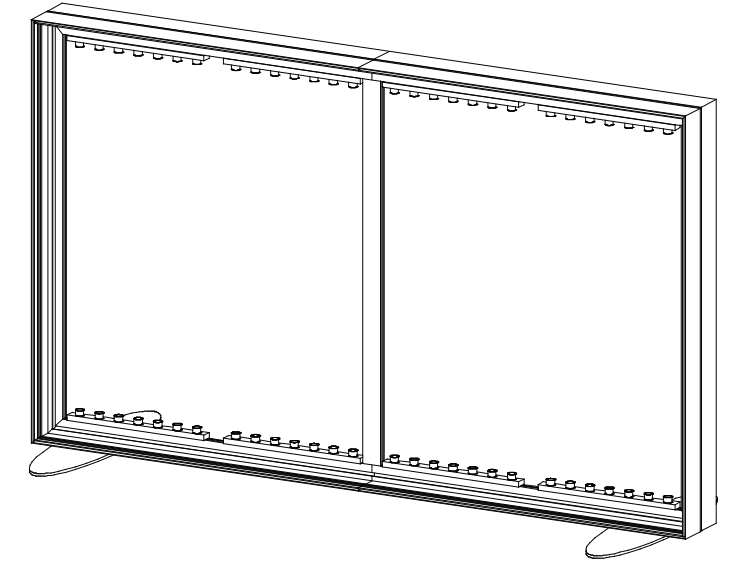
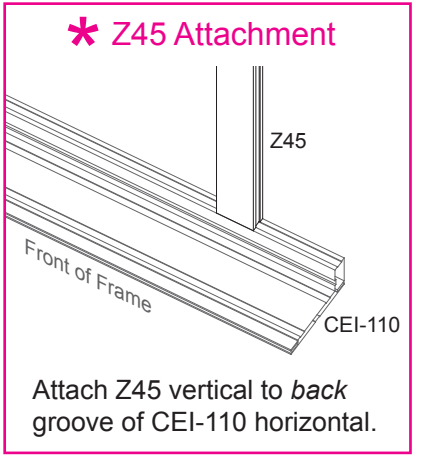

Completed Assembly

### SEG Graphic Installation

Corner A Corner B  
Corner D Corner C

It is important to first insert graphic into each alternate corner then to the sides of the frame. If this is not done, graphic will not fit into the frame correctly.

**Step 1**  
Insert corner A. Turn edge of graphic so silicon welt is perpendicular to face of graphic. Insert narrow side of welt with fabric to outside into the channel. Repeat for other side of this corner.

**Step 2**  
Repeat Step 1 for opposite corner C, then insert corner B, followed by corner D, to complete the installation of the corners.

**Graphic Removal**

To remove the graphic from the frame, locate the fabric pull tab. Gently pull up on the tab to remove the fabric.

**Step 3**  
Once all corners are inserted, press one silicon edge into channel from corners and work toward the center. Make sure welt is fully inserted into channel. Continue until all sides are done. Smooth out edges of graphic.

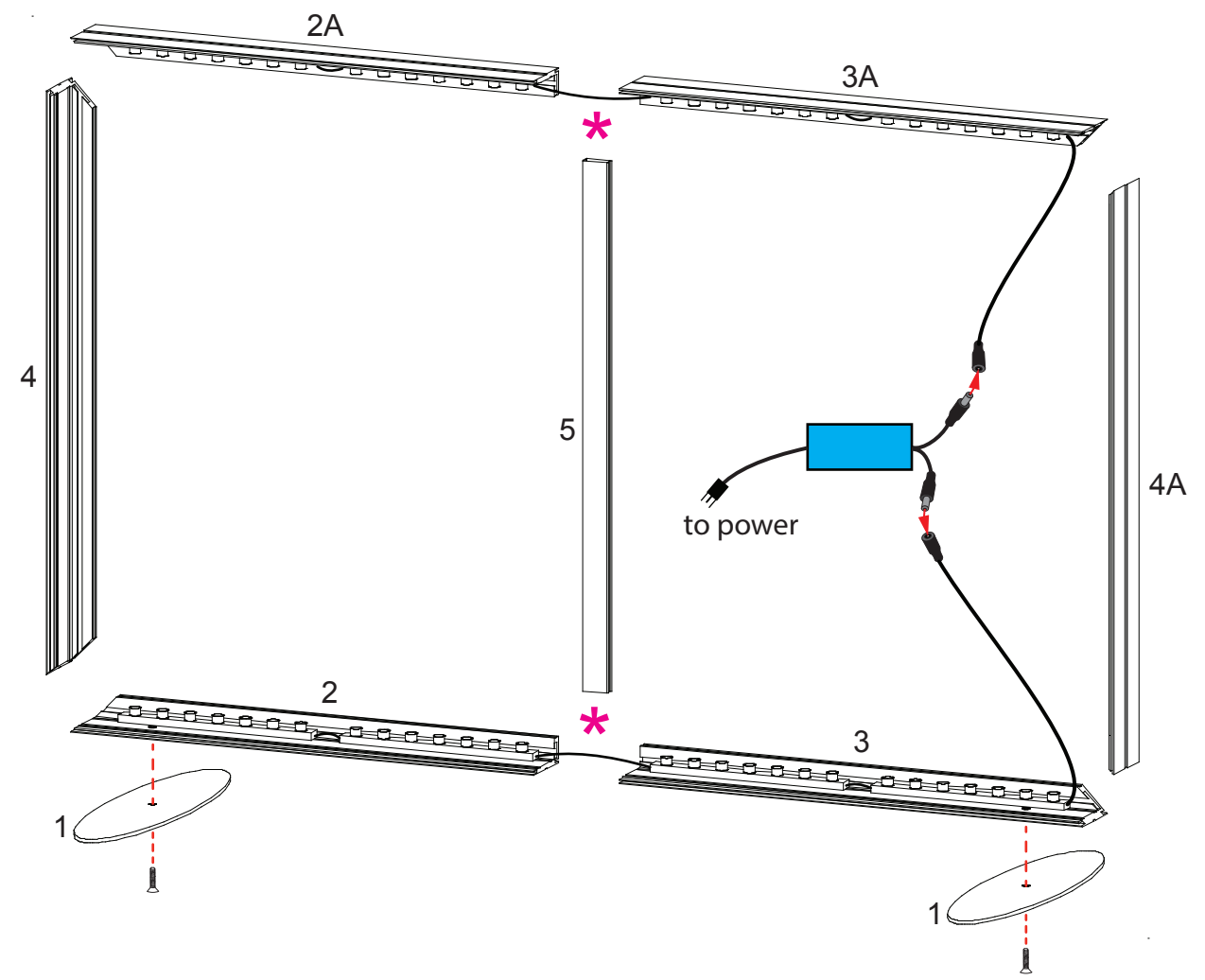

**Light to Light Connection**

Lights Female Male

---

**Light to Transformer Connection**

to power Female Male

Transformer  
96W / 4A / 24V

Maximum of 9 lights per transformer.

## Corner Bracket Assembly

- 1) Slide TWO-PIECE **TS RV 2** L-bracket into Interior Center Slot of extrusion so that two set screws are inside groove. Tighten two set screws to secure.
- 2) Slide one **A1** L-Bracket into outer interior grooves of upper and lower horizontals. Tighten set screws to secure.
- 3) Slide vertical extrusion over exposed ends of brackets in lower horizontal. Tighten set screws to secure.
- 4) Slide exposed ends of installed brackets of upper horizontal into open ends of verticals. Tighten set screws to secure.

## Disassembly

- 1) Loosen set screws on brackets and slide extrusions off of brackets.

### Corner Connection

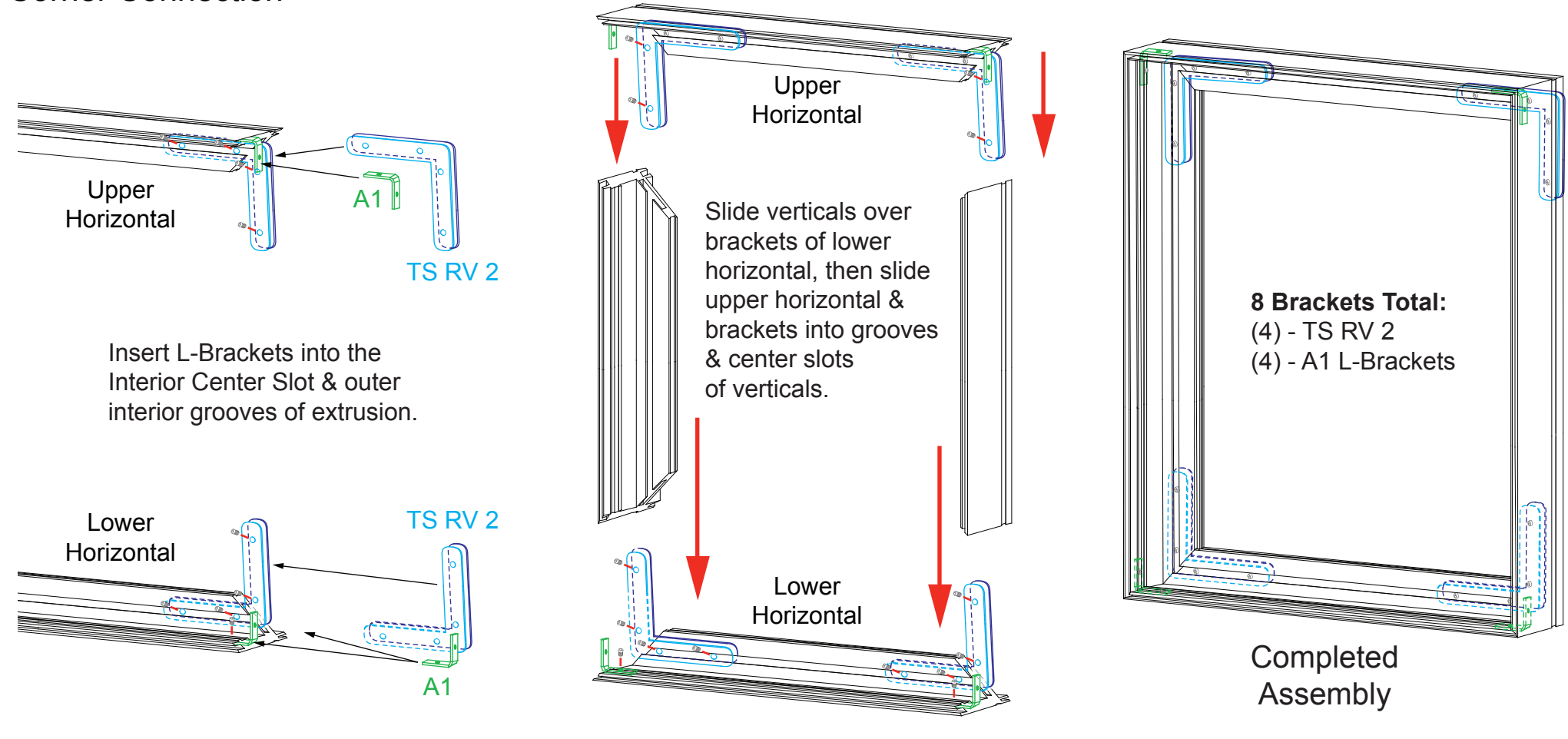

## Straight Bracket Assembly

- 1) Slide TWO-PIECE **TS RV 4** straight bracket into Interior Center Slot of extrusion, so that two of the set screws are inside groove. Tighten two set screws to secure.
- 2) Slide one **V4 Connector** into outer interior groove of extrusion, so that one set screw is inside groove. Tighten set screw.
- 3) Slide connecting extrusion over exposed ends of bracket & connector. Tighten all remaining set screws to secure extrusions.



### Straight Connection

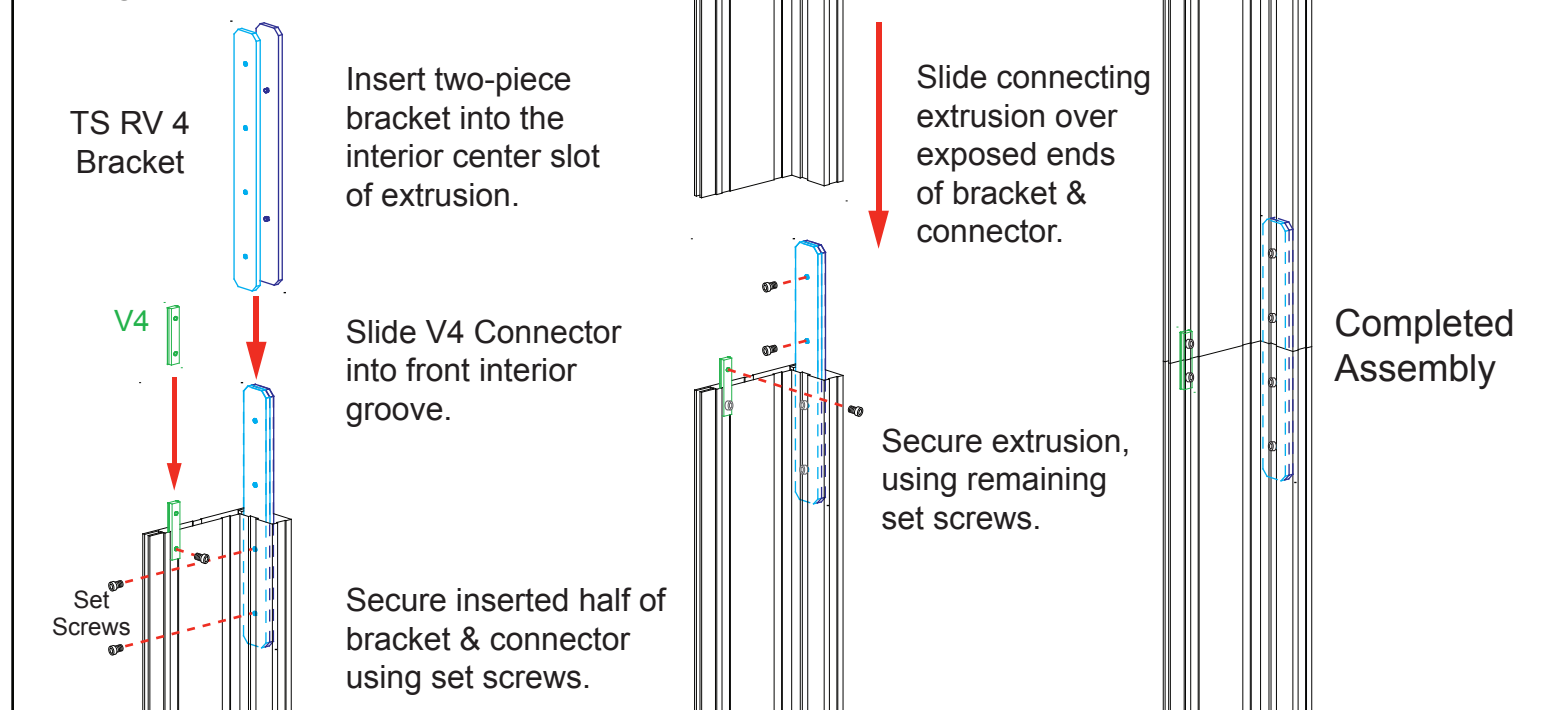

### Top View of Each Level

